

NWF CERTIFIED HABITAT CHECKLIST

FOOD

FOLIAGE FOR CATERPILLARS, MOTHS & SONGBIRDS - DESERT WILLOW

SEEDS FOR SONGBIRDS - GREEN HOPSEED BUSH

FRUIT / NECTAR FOR BUTTERFLIES, HUMMINGBIRDS AND POLLINATORS - FLOWERING SHRUBS IN 'NATIVE PLANTS USED'

PLACES TO RAISE YOUNG

DESERT MILKWEED - EGGS LAID BY MONARCH BUTTERFLIES

DESERT WILLOW - SHELTER FOR NESTING BIRDS

WATER

BUTTERFLY PUDDLING AREA - RIP RAP SWALE EXCAVATED TO PUDDLE WITH WATER WHEN IT RAINS

SUSTAINABLE PRACTICES

WATER CONSERVATION - DRIP OR SOAKER HOSE USED FOR IRRIGATION

CONTROLLING EXOTIC SPECIES - NATIVE PLANTS USED

COVER

COVER FROM WEATHER & PREDATORS - DESERT WILLOW, DESERT SPOON, GREEN HOPSEED BUSH, DESERT MILKWEED

NATIVE PLANTS USED

DESERT WILLOW, OCOTILLO, FAIRY DUSTER, BLUE GRAMA, PARRY'S PENSTEMON, DESERT SPOON, RED JUSTICIA,

DESERT MILKWEED, GREEN HOPSEED BUSH, DESERT MARIGOLD, MURPHEY'S AGAVE, BLACKFOOT DAISY

PROJECT SPECIFIC CHECKLIST
FOR BUTTERFLY GARDEN

378

LF 41.10
PAD 40.4

377

LF 41.50
PAD 40.8

376

LF 41.90
PAD 41.2

375

LF 42.30
PAD 41.6

374

LF 42.70
PAD 42.0

373

LF 43.00
PAD 42.3

372

LF 43.00
PAD 42.3

1'-0" VNAE
LIMIT OF WORK
TRACT JJJ

FULL BASKETBALL COURT -
SEE DETAIL 1, SHEET LA6.7

BOLLARD LIGHT (TYP.)
REFER TO ELECTRICAL
ENGINEER PLANS

20'X24' RAMADA -
SEE DETAIL 1,
SHEET LA6.4

PLAY AREA - SEE
DETAIL 1, SHEET LA6.6

6'-0" COMMUNITY TRAIL -
SEE DETAIL 1, SHEET LA6.2

TURF AREA - SEE
DETAIL 8, SHEET LA6.2

CONCRETE HEADER - SEE
DETAIL 3, SHEET LA6.2

BIRD BATH WITH RIP
RAP UNDERNEATH -
SEE LEGEND AND
DETAIL 4, SHEET LA6.4

BUTTERFLY GARDEN
(0.012 AC.) - SEE
DETAIL 1, SHEET LA6.5

ARBOR -
SEE DETAIL 8,
SHEET LA6.1

BENCH -
SEE DETAIL 7,
SHEET LA6.1

MATCHLINE RR ON STA PNT
33+00 ON VELVETWEED WAY
- SEE SHEET LA3.9

VELVETWEED WAY

MATCHLINE PP - SEE SHEET LA3.8

MATCHLINE WW - SEE BOTTOM
RIGHT SHEET LA3.15

STREETLIGHT (TYP.)
REFER TO ELECTRICAL
ENGINEER PLANS

8'-0" PUE
ROW
BOC

5'-0" ATTACHED
SIDEWALK, REFER TO
CIVIL ENGINEER PLANS

33'X33' SVT PER CIVIL
ENGINEER PLANS

DESERT MARIGOLD WAY.

32'-0" BOC

8'-0" PUE 50'-0" ROW

DRAINAGE STRUCTURE
- REFER TO CIVIL
ENGINEER PLANS

TRACT DDD

CLASS "A"
CONCRETE - SEE
CIVIL ENGINEER
PLANS

TRACT CCC

33'X33' SVT PER CIVIL
ENGINEER PLANS

LIMIT OF WORK

ARTIFICIAL TURF -
SEE DETAIL 8,
SHEET LA6.2

33'X33' SVT PER
CIVIL ENGINEER
PLANS
40'



Scale 1:20'

PLANT MATERIALS LEGEND

Tree	Box (in.)	Qty
Acacia aneura	24"	23
Mulga Acacia	24"	9
Chilopsis linearis	24"	19
Desert Willow	24"	3
Ebenopsis ebano	24"	4
Texas Ebony	24"	134
Fraxinus velutina 'Rio Grande'	24"	31
Fan-Tex Ash	24"	11
Lysiloma microphylla	24"	60
Desert Fern	24"	125
Cercidium hybrid 'AZT'	24"	206
AZT Thornless Palo Verde	20' Max Height	50
Phoenix dactylifera		
Date Palm		
Pistacia chinensis	24"	
Chinese Pistache	24"	
Prosopis hybrid	24"	
Thornless Mesquite	24"	
Prosopis glandulosa	24"	
Thornless Honey Mesquite	24"	
Quercus virginiana	24"	
Southern Live Oak	24"	
Ulmus parvifolia 'Bosque'	24"	
Bosque Elm	24"	

Extra Large Shrubs	Size	Qty	Small Shrubs	Size	Qty
Caesalpinia gillesii	5 gal.	8	Bougainvillea 'Alexandra'	5 gal.	120
Yellow Bird of Paradise	5 gal.	166	Alexandra Bougainvillea	5 gal.	3
Caesalpinia pulcherrima	5 gal.	233	Russelia equisetiformis	5 gal.	3
Red Bird of Paradise	5 gal.	194	Groundcovers	Size	Qty
Cordia parvifolia	5 gal.	97	Baileya multiradiata	1 gal.	14
Little Leaf Cordia	5 gal.	5	Desert Marigold	1 gal.	29
Dodonaea viscosa	5 gal.	5	Eremophila prostrata	1 gal.	130
Hopbush	5 gal.	5	Outback Sunrise Eremophila	1 gal.	130
Tecoma alata 'Orange Jubilee'	5 gal.	5	Lantana montevidensis	1 gal.	130
Orange Jubilee	5 gal.	5	Purple Trailing Lantana	1 gal.	130
Tecoma x 'Bells of Fire'	5 gal.	5	Lantana sp.	1 gal.	318
Bells of Fire	5 gal.	5	'New Gold' Lantana	1 gal.	177
Large Shrubs	Size	Qty	Lantana sp.	1 gal.	177
Calliandra californica	5 gal.	222	'New Red' Lantana	1 gal.	16
Red Fairy Duster	5 gal.	114	Verbena gooddingii	1 gal.	16
Justicia californica	5 gal.	38	Gooding Verbena	1 gal.	16
Red Chuparosa	5 gal.	65	Cacti/ Accents	Size	Qty
Larrea tridentata	5 gal.	474	Aloe hyb. 'Blue Elf'	5 gal.	222
Creosote	5 gal.	18	Blue Elf Aloe	5 gal.	17
Leucophyllum laevigatum	5 gal.	18	Asclepias subulata	5 gal.	17
Chihuahuan Sage	5 gal.	18	Desert Milkweed	5 gal.	17
Leucophyllum langmaniae	5 gal.	18	Bouteloua gracilis	1 gal.	38
Lynn's Legacy Sage	5 gal.	18	Blonde Ambition	1 gal.	38
Lycium fremontii	5 gal.	18	Hesperaloe funifera	5 gal.	18
Fremont Lycium	5 gal.	18	Giant Hesperaloe	5 gal.	18
Medium Shrubs	Size	Qty	Hesperaloe parviflora 'Brakelights'	3 gal.	235
Anisacanthus thurberi	5 gal.	2	Brakelights Red Yucca	3 gal.	189
Desert Honeysuckle	5 gal.	271	Muhlenbergia rigens	1 gal.	189
Eremophila glabra spp. carnososa	5 gal.	216	Podranea ricasoliana	5 gal.	4
Winter Blaze	5 gal.	28	Pink Trumpet Vine	5 gal.	4
Eremophila hygrophana Blue Bells	5 gal.	28	Inerts		
Blue Bells	5 gal.	22	Decomposed Granite - 3/4" Screened		
Leucophyllum frutescens 'Compacta'	5 gal.	22	1" Screened for slopes and Flow Channels		
Compact Texas Sage	5 gal.	22	Santa Fe Gold - Pioneer Materials		
Perovskia atriplicifolia	5 gal.	22	2" Depth in Planting Areas		
Russian Sage	5 gal.	22	Mid Fron Sod		
Ruellia peninsularis	5 gal.	22	Artificial turf		
Desert Ruellia	5 gal.	22	Mounded 8" at Roundabouts		
			WoodFiber		

NOTES:
1. ALL TREES SHALL COMPLY WITH THE LATEST AMENDED EDITION OF THE "ARIZONA NURSERY ASSOCIATION - RECOMMENDED TREE SPECIFICATIONS." SEE SECTION 1903(6)(A), ZONING CODE.
2. ALL LANDSCAPE AREAS TO BE IRRIGATED WITH AUTOMATIC UNDERGROUND IRRIGATION SYSTEM.
3. ALL LANDSCAPE AREAS TO BE MAINTAIN IN A WEED FREE CONDITION BY AN HOA SELECTED BY THE OWNER.

TRACT DDD
CLASS "A" CONCRETE - SEE CIVIL ENGINEER PLANS
TRACT CCC

33'X33' SVT PER CIVIL ENGINEER PLANS
LIMIT OF WORK
ARTIFICIAL TURF - SEE DETAIL 8, SHEET LA6.2

33'X33' SVT PER CIVIL ENGINEER PLANS
40'

KEY MAP

NOT TO SCALE

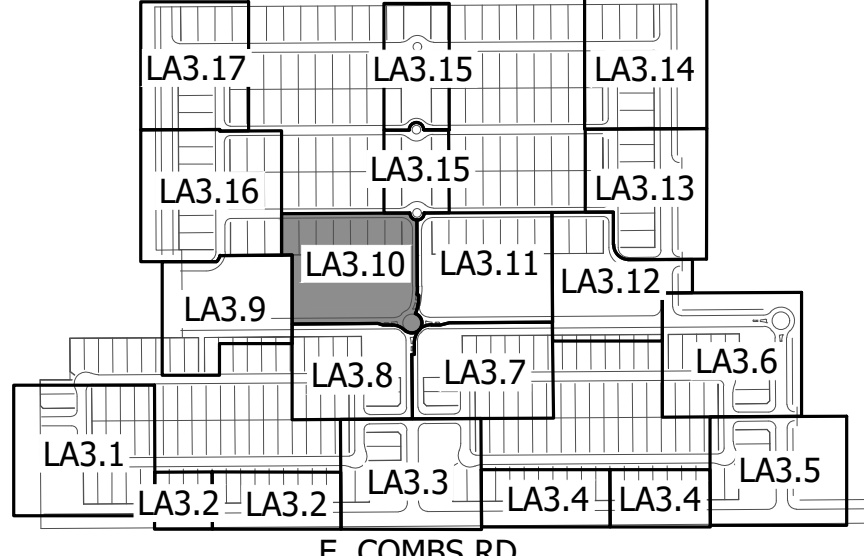

PINAL COUNTY SPR #: FP22-005

DATE: 10.07.2022
ISSUED FOR: CITY SUBMIT
DRAWN BY: VL
CHECKED BY: TD
PERMIT NUMBER:
ABLA PROJECT NUMBER:
10-432-21

LA3.10

PG: 17 OF 59